

GREATER ASTORIA HISTORICAL SOCIETY

THE HISTORY

THE SOCIETY

PRESERVATION

GAHS STORE

HOME

LIRR SERVICE to:

- [Van Iderstine Co.](#)
- [Shaw-Walker Co.](#)
- [Bickfords and Peter F. Mallon](#)
- [Eagle Electric #7](#)
- [Extrin](#)
- [Roto-Broil](#)
- [Walworth Craftsman, Westinghouse](#)
- [Slicklen Paper](#)
- [Sternberger](#)
- [National Casket](#)
- [Brenner Paper](#)
- [Louis Sherry](#)
- [Speed Queen](#)
- [American Steel Wool](#)
- [Web Offset](#)
- [Astoria Lumber](#)
- [West Chemical](#)
- [Blissville Yard](#)
- [Jacobson & Son](#)
- [Stoll Metal](#)
- [Marlyn Warehouse](#)
- [Yard A](#)
- [Dutch Kills Lift Bridge](#)
- [Carbona Products](#)
- [Centre Lumber](#)

[Back to Transportation](#)

GAHS STORE



Books



Images



Merchandise

HISTORY TOPICS: TRANSPORTATION: LIRR



VOLUME 20: LONG ISLAND RAILROAD SERVICE TO BLISSVILLE'S STOLL METAL

By Nicholas Kalis

Twenty in a series of glimpses into industries or warehouses that made for interesting freight operations on the Long Island. Information presented has included, where available, a brief history of the firm, how it was served by the LIRR, and what commodities were received or shipped from this facility.

Maps of Freight Stations and Private Sidings (June 1966) at page 7 identifies Blissville's Stoll Metal as Spot 2 . Stoll shared a siding with Carbona (Spot 1). To the east, on a separate siding is Centre Lumber (Spot 3). Spot 2 had a capacity of one car. Stoll Metal, in the Borough of Queens, was at 36-08 Review Avenue with telephone number Ironsides 6-3641 This firm had originally been at 49 Dupont Street, Brooklyn, according to telephone directories of 1940 through 1942. By 1959/60 this address was listed as *Paragon Smelting Corp* with telephone number RA 9-3641 and 729-3641. By 1970, a revised map showed *Durable Metals* as Spot 2. It is possible this spot was the site of Truscon Steel some time prior to 1959/60.

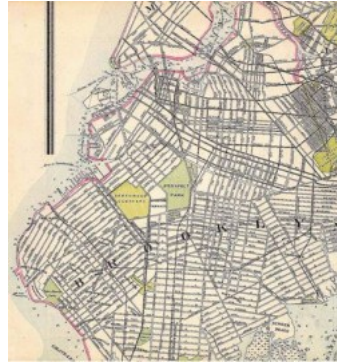

Truscon Steel operated warehouses in the northeast, handling reinforcing bar and building products of the era (steel doors, frames, window sash, hot rolled and cold formed steel sections and aluminum.) According to Dean E. Robb, Truscon Steel did not own Stoll Metal, but could have leased the warehouse or had some other business arrangement with them since most of the warehouse facilities were leased/rented rather than owned. Fabrizio believes the monitor-roofed building is similar in design to the United States Metal Plating Company which was adjacent to Dutch Kills. Given both firms worked with metals, they would have a similar design in structure.



LIRR Photographer, July 30, 1936 slide, buildings of Standard Oil in the distance, to the left. Van Iderstine is west of Standard Oil on both sides. Camera is looking West. Credit: Art Huneke Collection

Bliss Yard Drill would return to Yard A at the end of an 8-hour trick. Bliss Yard also had a later 3:00 PM Drill. Bliss Yard Drill used no hack for its one-mile trip to Blissville Yard.



Stoll Metal (Spot 2) was on the right hand side of the tracks beyond Van Iderstine Spots 5a and 5b (beyond the vertical tanks) at right side of photograph (photo looking West). Spot 5c is on left side of photograph, past switch. Greenpoint Avenue Bridge in background. Vantage point is furthest East of all photos appearing in this article. Arthur Huneke, September 10, 1982, Color Slide, Credit: Arthur Huneke Collection

Modeling

Those wishing to model Stoll would benefit from consulting the pictures in this article. Anyone wishing to help this author model Stoll on his HO scale layout is encouraged to contact him with any offers of assistance.



Closest covered hopper lettered ECUX Exxon Chemical USA confirms building on the right is Allied Extruders, formerly Carbona (Spot 1 or 36-06? Review Avenue between Greenpoint Avenue Bridge and Stoll Metal. Greenpoint Avenue Bridge in background. Camera looking West Arthur Huneke Color Slide, September 10, 1982. Credit: Art Huneke Collection

According to Tony Fabrizio, Stoll Metal is likely the building with the Monitor roof (photo looking West), Greenpoint Avenue Bridge in background. Arthur Huneke Color Slide, September 10, 1982, Credit: Arthur Huneke Collection

Credits

and Bob Miller of the Queens Borough Public Library and Art Huneke is also gratefully acknowledged.

Photography

Author Unknown *Maps of Freight Stations and Private Sidings* (Reprint) June 1966

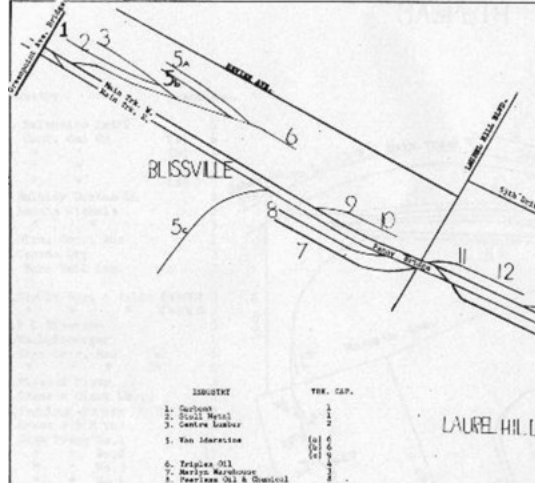

Maps of Freight Stations and Private Sidings 1966 showing Stoll Metal as Spot 2

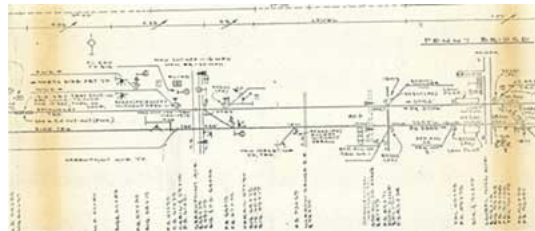

Blueprints from Art Huneke Collection

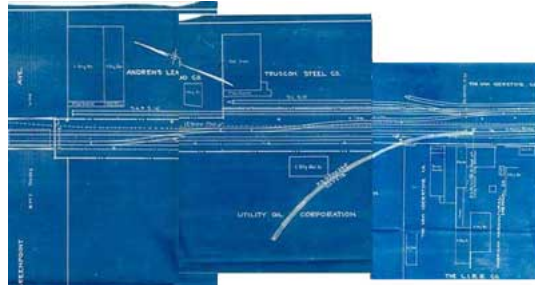

Andrews Lead Co. at Greenpoint and Review Avenues was a predecessor of both Carbona (Spot1) and Stoll Metal (Spot2). Truscon Steel at 37-10 Review Avenue was the predecessor to Centre Lumber(Spot 3). In 1931, Truscon Steel Co. was purchased by Republic Steel, but continued to operate as Truscon until the early 1960s.

Blueprints from Art Huneke Collection

RELATED PAGES

Website : LIRR Freight Stations and Private Sidings



Search input field

Search

Search GAHS Website

Search WWW

Home | About Us | Contact Us | About this Website



Copyright 1999-2007 Greater Astoria Historical Society